

Prepared by:

JDA Consultants Pty Ltd.

Consulting Surveyors & Town Planners.

ACN 010 272 090

50 Prospect Street, Fortitude Valley

Ph: 07 3252 3777

Fax: 07 3252 1291

Email: jdass@acenet.net.au

Plan Showing:

Area to be leased (Hatched) being part of Level Eight (13th Floor of the 15 Floor Building) situated on Lot 2 on RP 139280

Parish: Enoggera

County: Stanley

Title Reference: 17494233

Note:

Area calculated as per Gross Lettable Area Retail, Property Council of Australia, Method of Measurement March 1997. Being measurements taken to the inside of external walls and glass, to the midline of inter-tenancy walls and corridor side of corridors. The lift lobby is included in the calculated area of this lease.

CP

BUP 103480

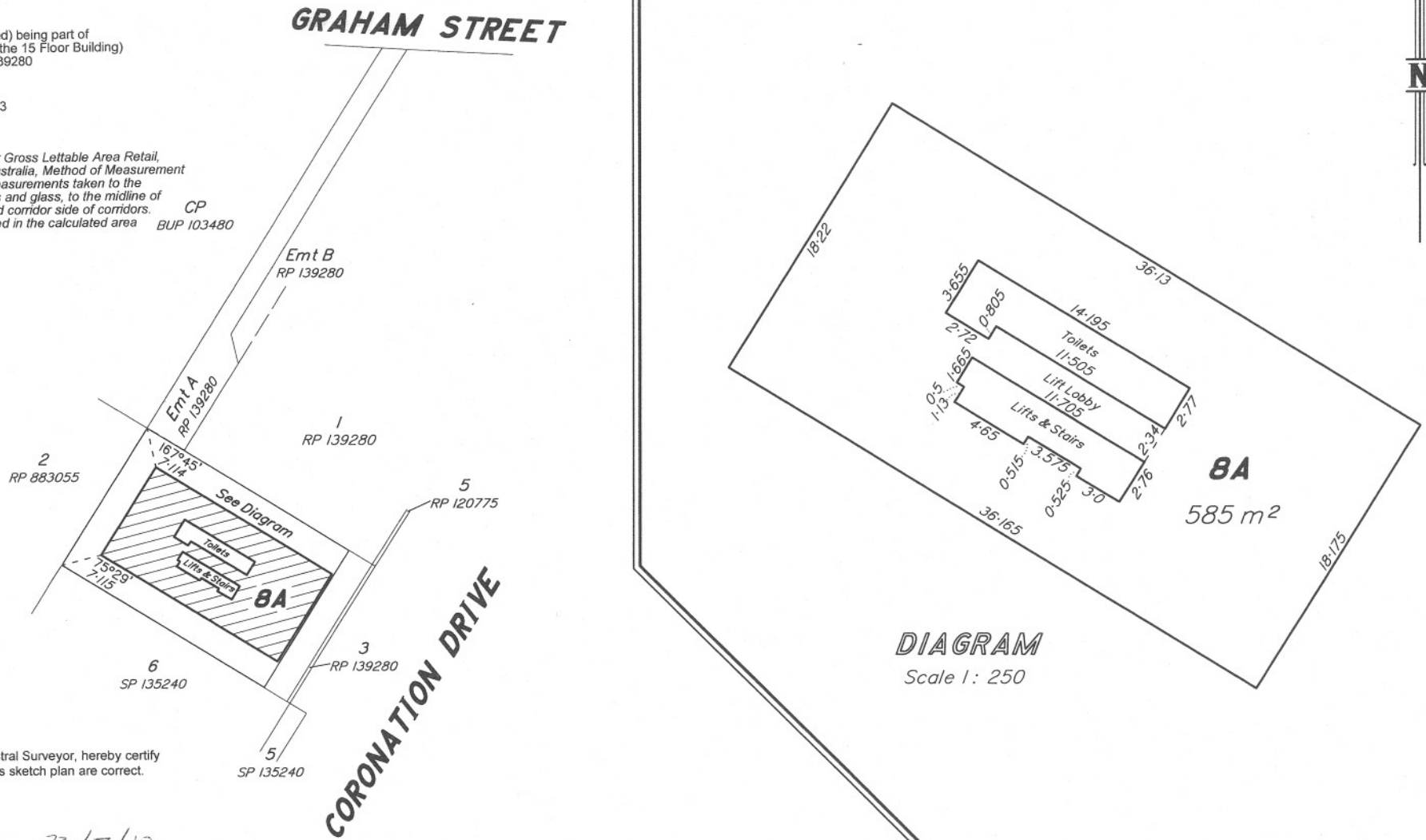

I John de LaCouture, Cadastral Surveyor, hereby certify that the details shown on this sketch plan are correct.

John de LaCouture
Cadastral Surveyor

23/7/10
Date

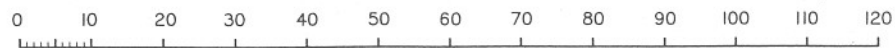

Scale 1:750 Lengths are in Metres