

Prepared by:  
**JOHN DEE & ASSOCIATES PTY LTD**

Consulting Surveyors ACN 010 272 090  
 50 Prospect Street, Fortitude Valley  
 Ph: 3252 3777 3852 1634  
 Mobile: 0418 722 305  
 Fax: 3252 1291  
 Email: jdass@acenet.net.au

**Plan Showing:**

Area to be leased being part of the ground floor of the building situated on Lot 1 on RP210262  
 Parish of North Brisbane  
 County of Stanley  
 Title Reference: 17528092

**Note:**

Area calculated as per Gross Lettable Area Retail (Property Council of Australia) being measurements taken to the inside of external walls and midline of inter-tenancy walls.

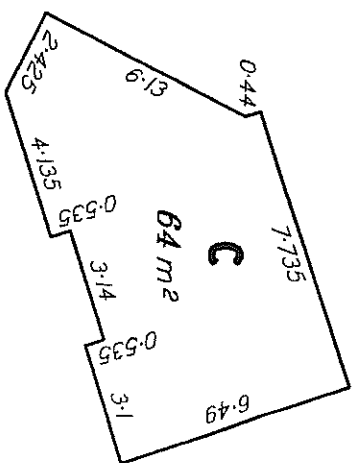
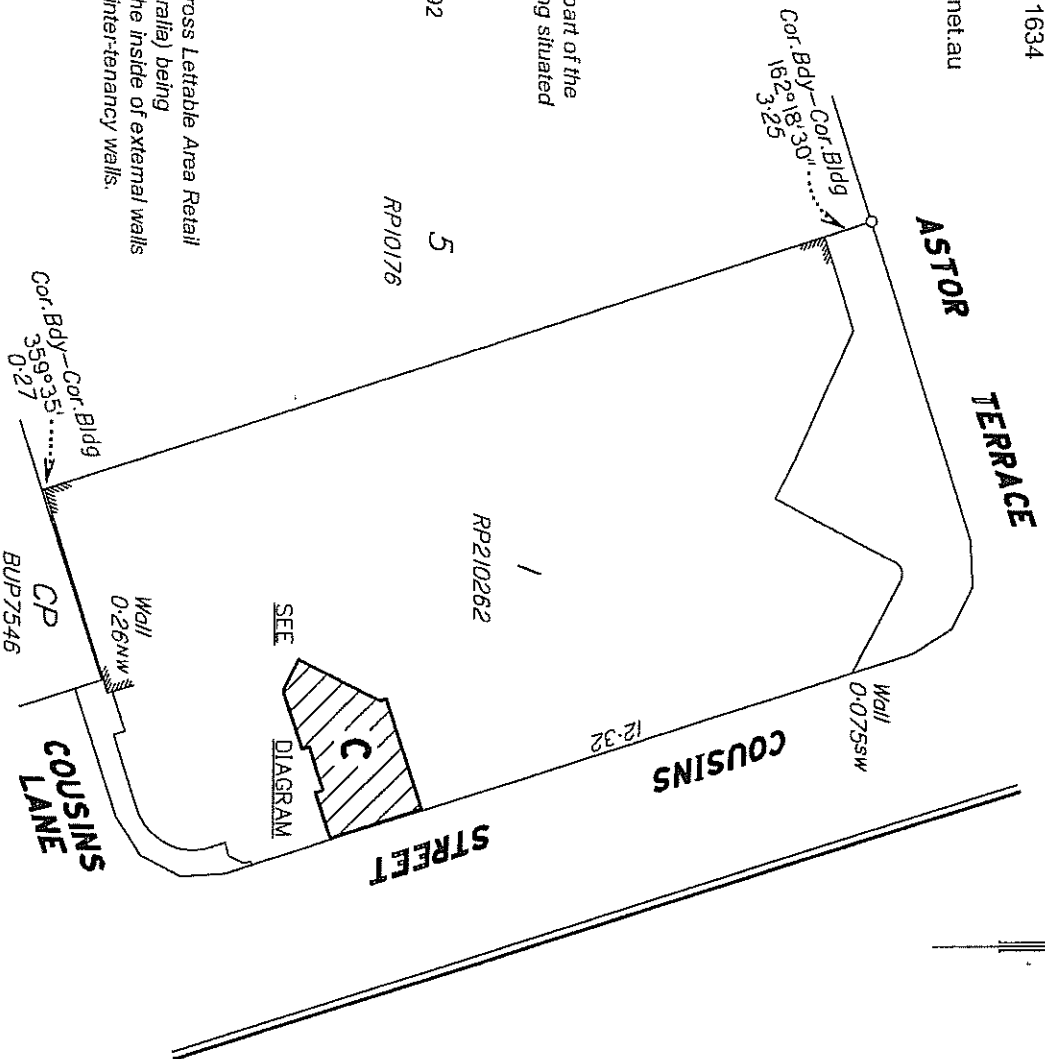

**DIAGRAM**

Scale 1:200

Scale 1:500 - Lengths are in Metres.

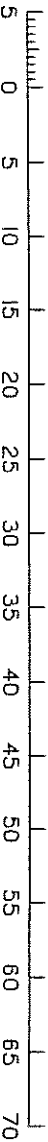

P45, 20704C.dwg  
 207/04

I, Justin William Davis, Registered Surveyor Land, hereby certify that the details shown on this sketch plan are correct.

*JWD*  
 Registered Surveyor Land

13/4/05  
 Date