

Prepared by:  
**JOHN DEE & ASSOCIATES PTY LTD**

Consulting Surveyors ACN 010 272 090  
 50 Prospect Street, Fortitude Valley  
 Ph: 3252 3777 3852 1634  
 Mobile: 0418 722 305  
 Fax: 3252 1291  
 Email: jdass@acenet.net.au



**Plan Showing:**

Area to be leased (hatched) being part of the ground floor of the building situated on Lot 2 on RP 139280  
 Parish of Enoggera  
 County of Stanley  
 Title Reference: 17494233

**Note:**

Area calculated as per Gross Lettable Area, Retail (Property Council of Australia) being measurements taken to the inside of external walls and glass, midline of inter-tenancy walls and corridor side of corridors

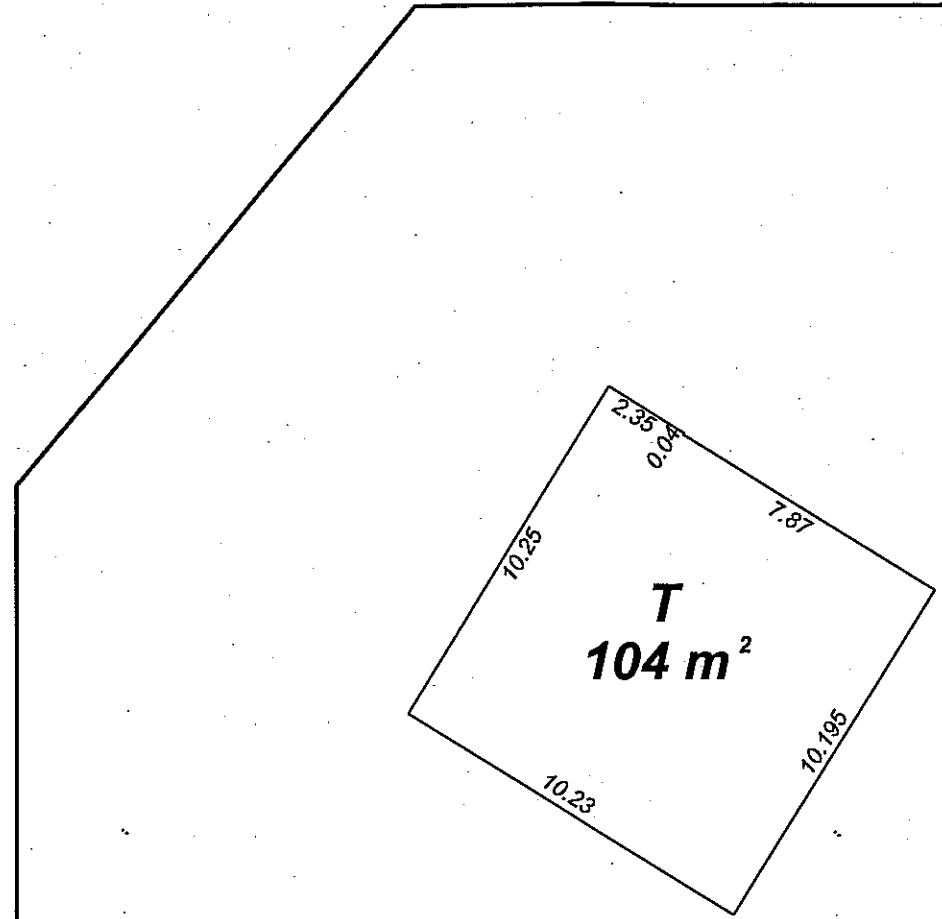
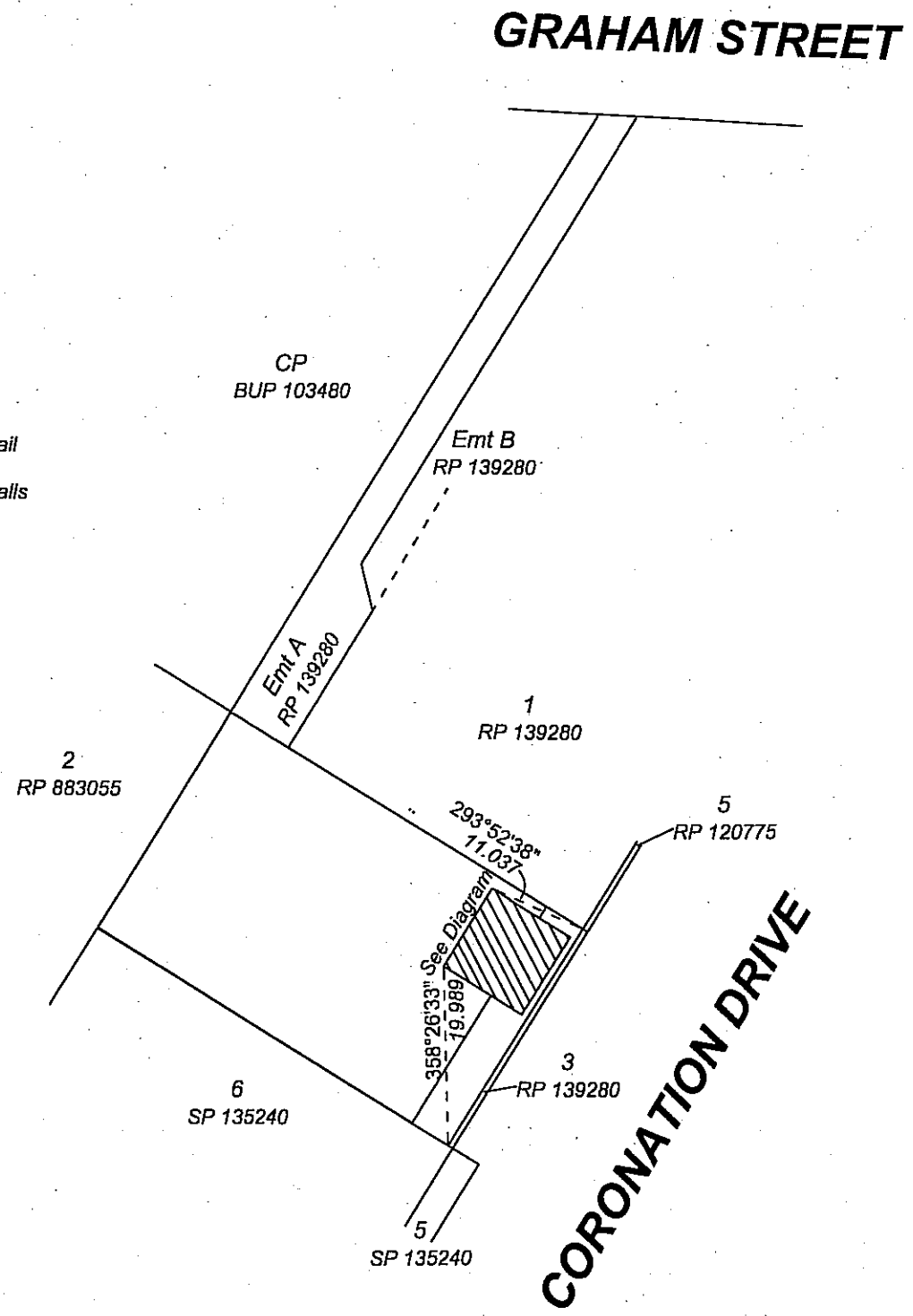
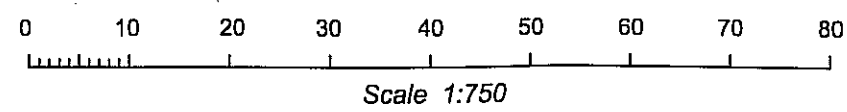

Diagram  
 Scale 1 : 200



I Justin William Davis, Cadastral Surveyor, hereby certify that the details shown on this sketch plan are correct.

*Justin William Davis*  
 Cadastral Surveyor

16/5/06  
 Date