

Prepared by:

JOHN DEE & ASSOCIATES PTY LTD

Consulting Surveyors ACN 010 272 090

50 Prospect Street, Fortitude Valley

Ph: 3252 3777 3852 1634

Mobile: 0418 722 305

Fax: 3252 1291

Email: jlass@acenet.net.au

Plan Showing:

Area to be leased being part of the
ground floor of the building situated
on Lot 1 on RP210262
Parish of North Brisbane
County of Stanley
Title Reference: 17528092

Note:

Area calculated as per Gross Lettable Area Retail
(Property Council of Australia) being
measurements taken to the inside of external walls
and glass and midline of intertenancy walls.

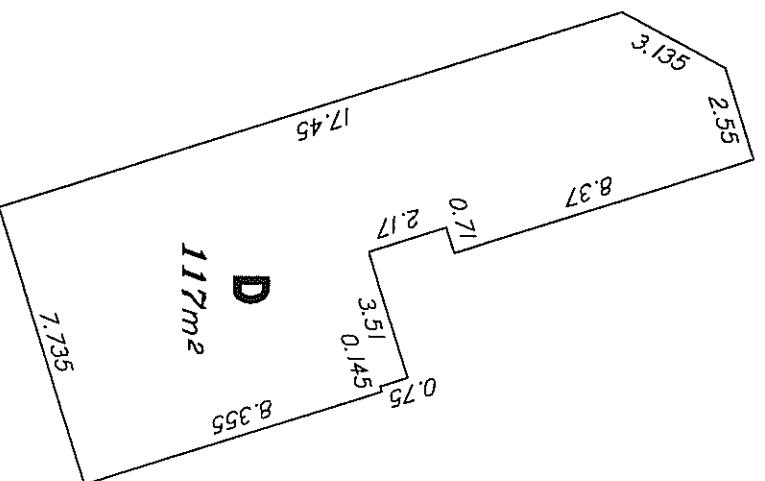
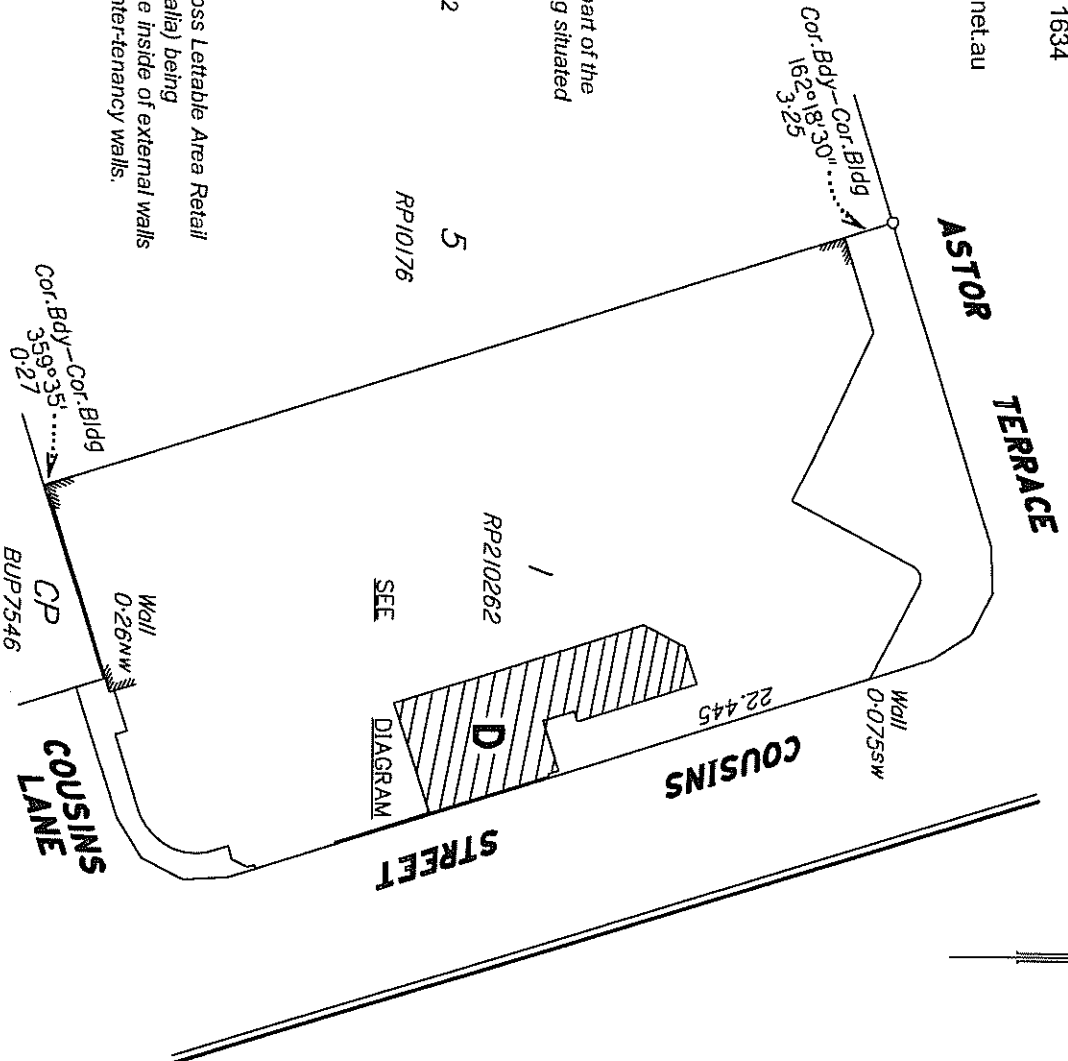

DIAGRAM

Scale 1:200

I, Justin William Davis, Registered Surveyor Land,
hereby certify that the details shown on this sketch
plan are correct.

Justin Davis

Registered Surveyor Land

9/5/05

Date

P45, 20704D.dwg
207/04

Scale 1:500 - Lengths are in Metres.

