

Prepared by:

**JDA Consultants Pty Ltd.**

Consulting Surveyors & Town Planners.

ACN 010 272 090

50 Prospect Street, Fortitude Valley

Ph: 07 3252 3777

Fax: 07 3252 1291

Email: [jdass@jdaconsultants.net.au](mailto:jdass@jdaconsultants.net.au)

**PLAN FOR LEASE PURPOSES**

Plan Showing :

Area to be leased (Hatched) being part of the Eighth Floor of the building situated on Lot 1 on RP 139280

Parish : Enoggera

County : Stanley

Title Reference : 16391115

Note :

Area Calculated as per the Property Council of Australia, Method of Measurement March 1997, Net Lettable Area, being measurements taken to the inside face of external building walls & glass, inside face of walls abutting lifts, fire stairs, toilets, services, and service floor risers, to the corridor side of corridors & public spaces and to the midline of inter-tenancy walls.

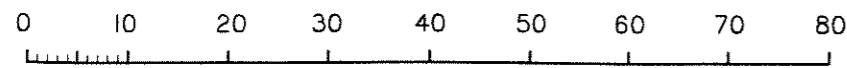
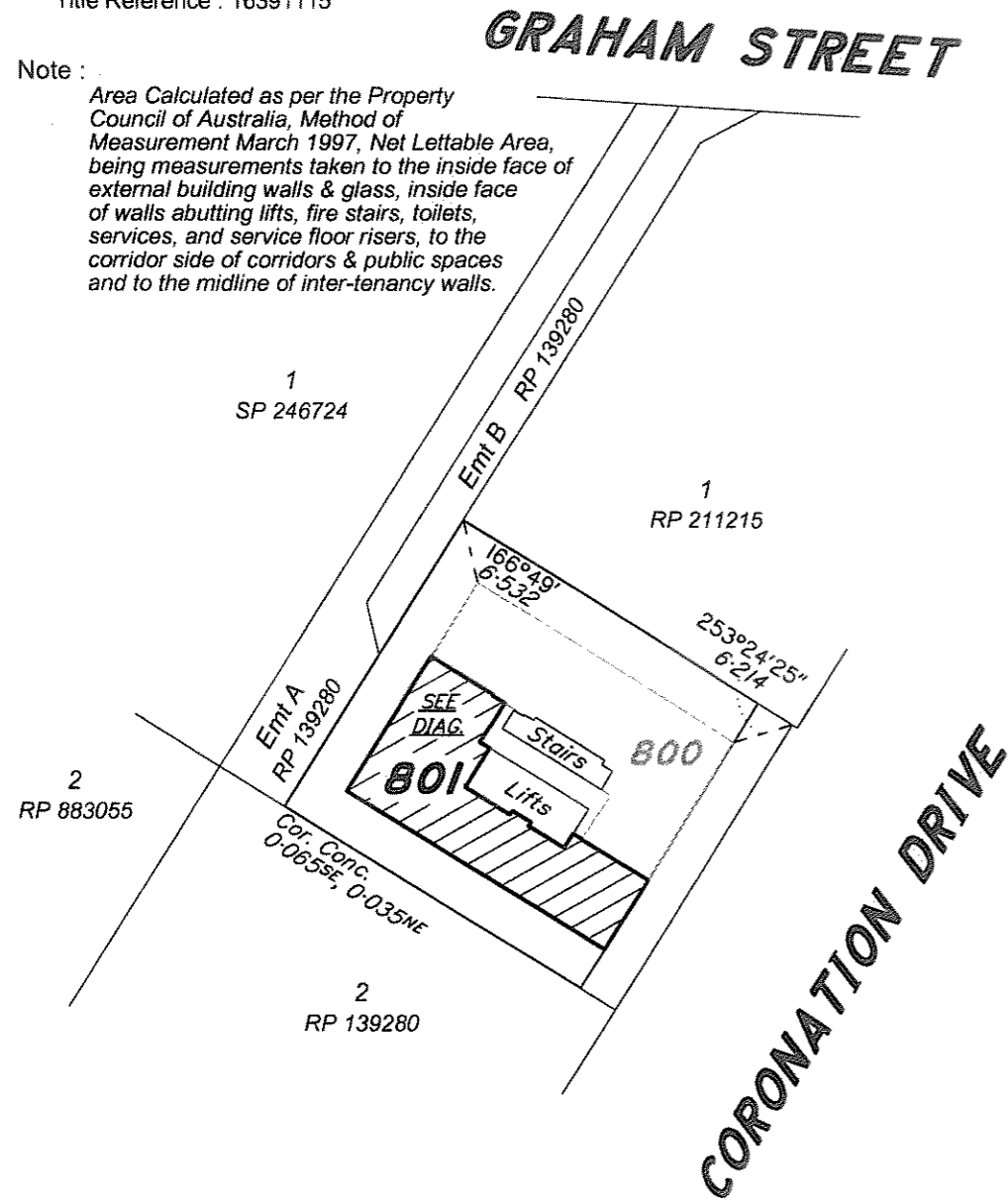

Scale 1: 750 Lengths are in Metres.

For registration plan MUST be to scale.  
(DO NOT REDUCE OR ENLARGE)

Sheet of

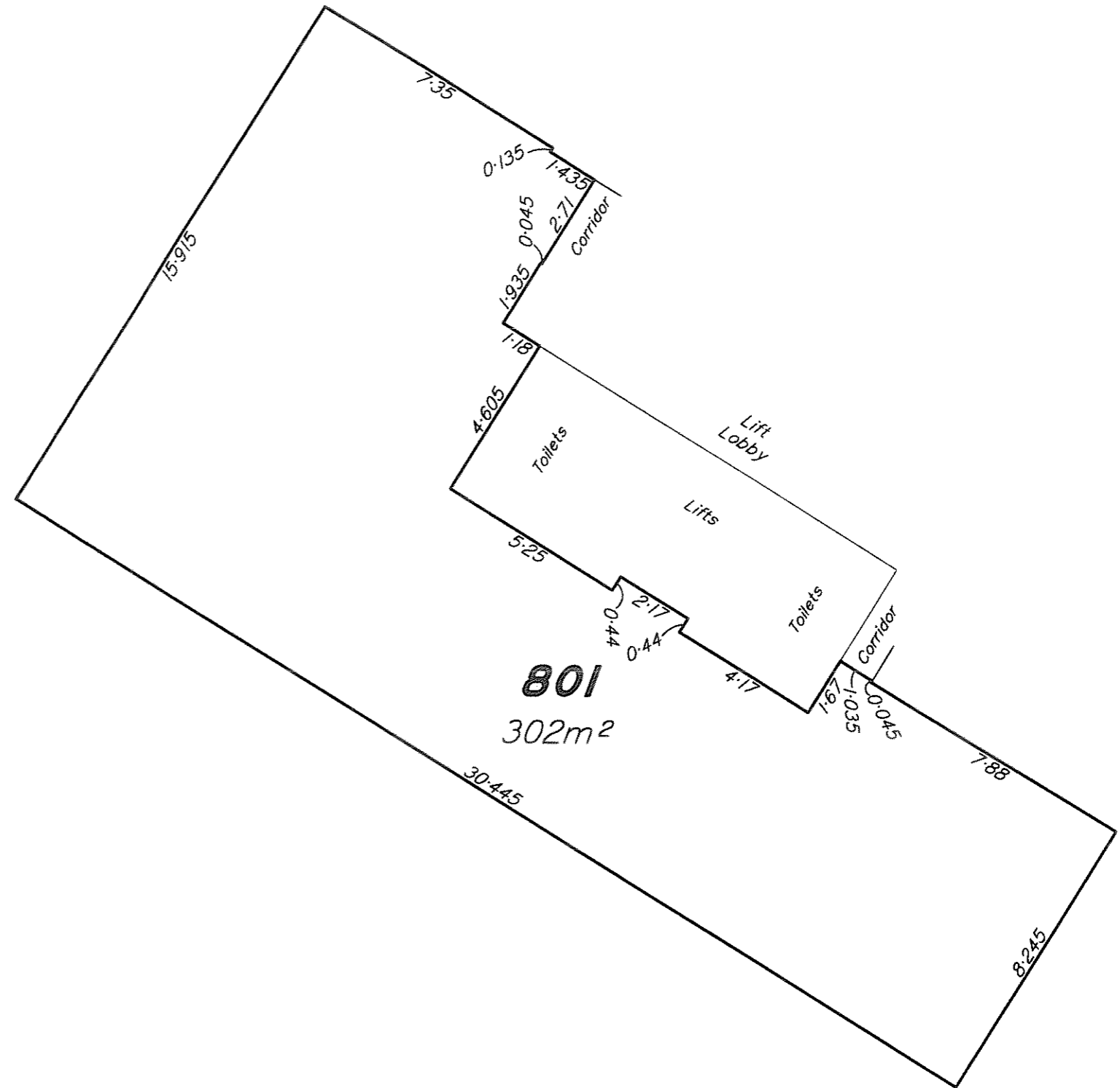

**DIAGRAM**

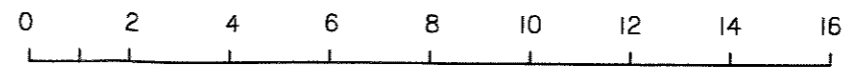

Scale 1: 150 on A3. Lengths are in Metres.

I John Martin Gibson, Cadastral Surveyor, hereby certify that the details shown on this sketch plan are correct.

*John Martin Gibson*  
Cadastral Surveyor

1/4/15  
Date