

Prepared by:

**JDA Consultants Pty Ltd.**  
Consulting Surveyors & Town Planners.  
ACN 010 272 090  
50 Prospect Street, Fortitude Valley  
Ph: 07 3252 3777  
Fax: 07 3252 1291  
Email: jdass@jdaconsultants.net.au

For registration plan MUST be to scale.  
(DO NOT REDUCE OR ENLARGE)

Sheet of

**PLAN FOR LEASE PURPOSES**

**Plan Showing :**

Area to be leased (Hatched) being part of  
of the Level Five (10th floor of the 15 Floor Building) of the building  
situated on Lot 2 on RP 139280  
Parish : Enoggera  
County : Stanley  
Title Reference : 17494233

**Note :**

Area calculated as per Property Council of Australia,  
Method of Measurement March 1997, Net Lettable Area.  
Being measurements taken to the inside of external walls  
and glass, also to walls abutting Lifts, Fire Stairs, toilets and services.  
To the the corridor side of walls abutting corridors and lift lobbies.  
To the midline of inter-tenancy walls.

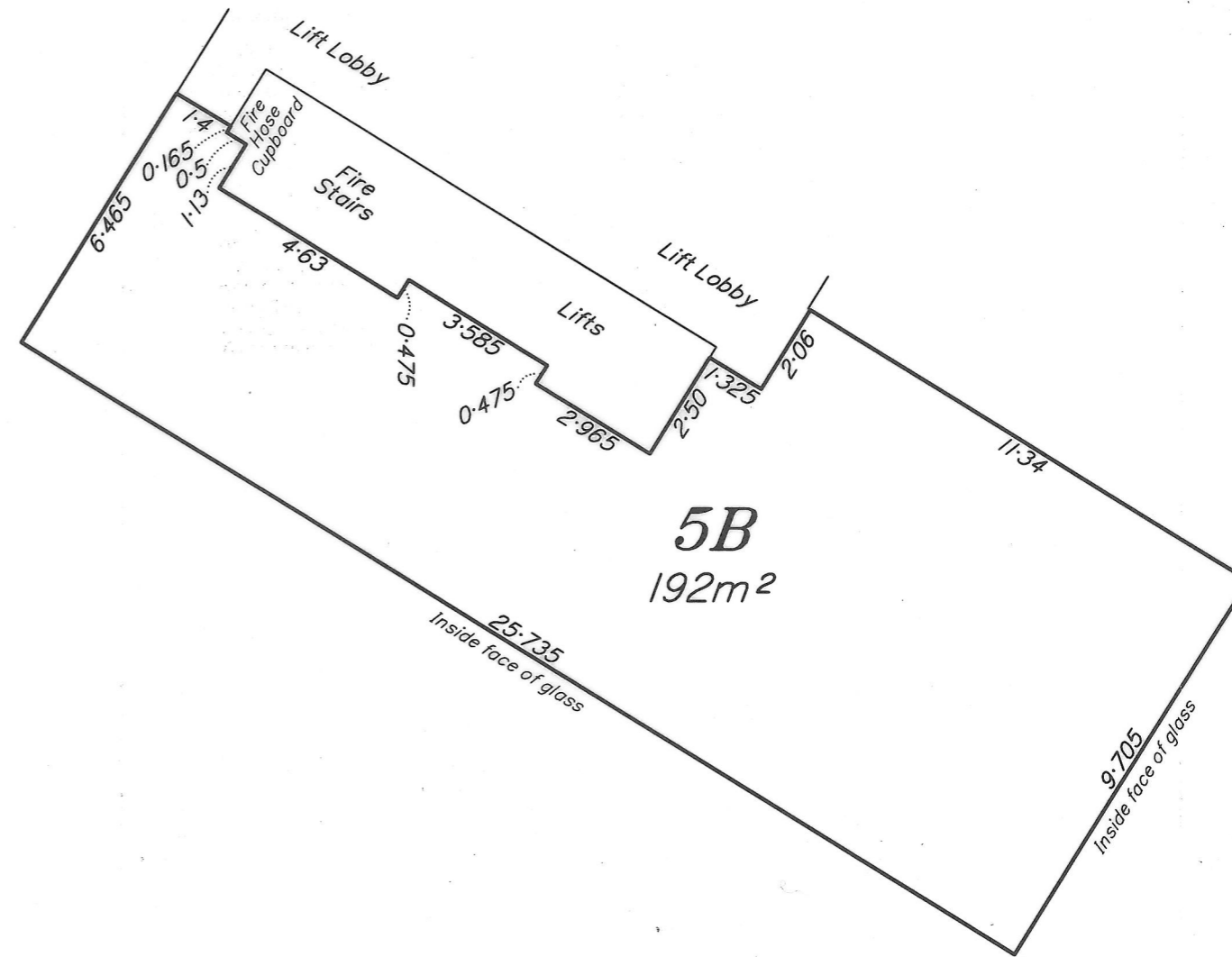
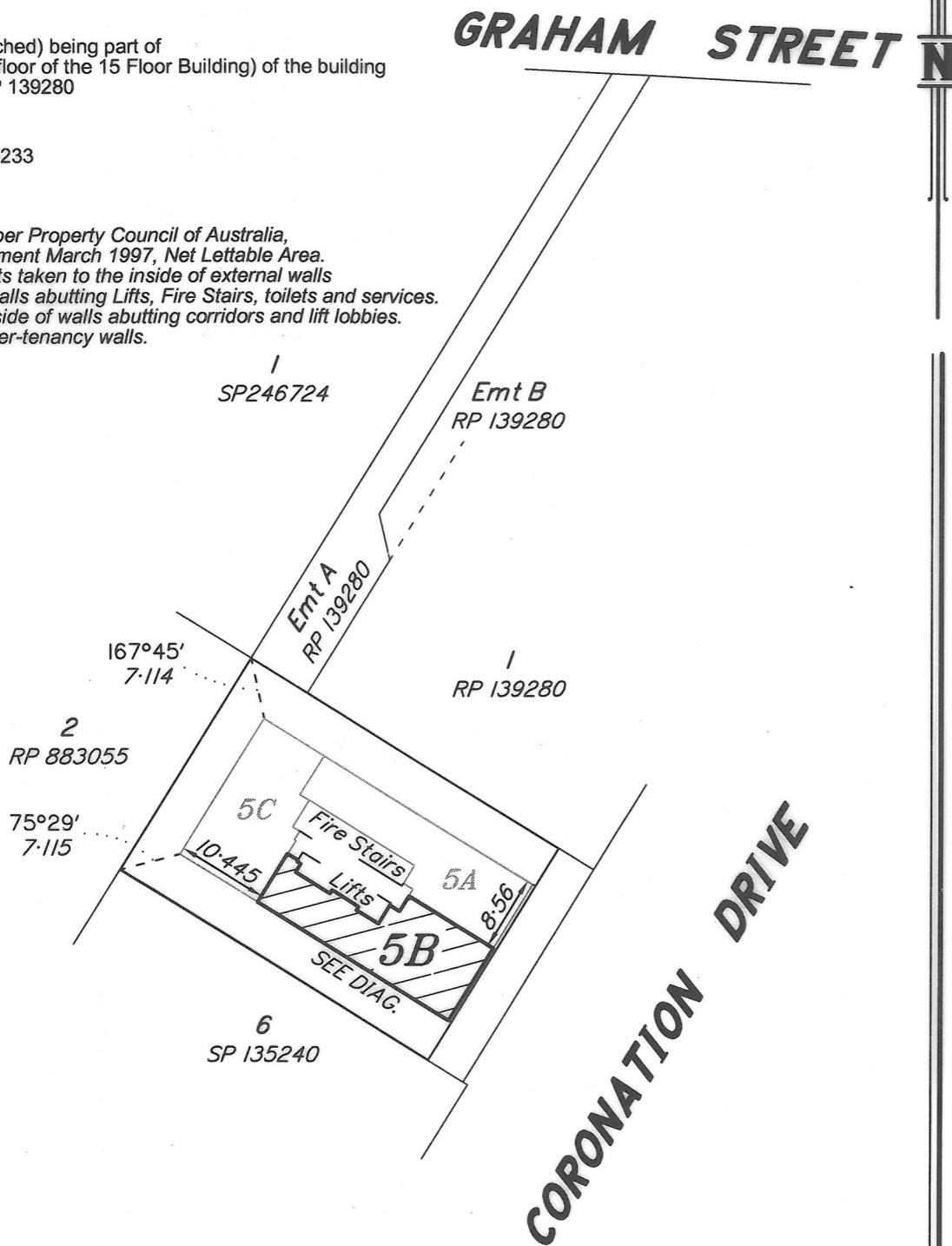

**DIAGRAM**

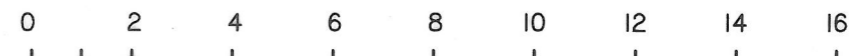

Scale 1: 150 on A3. Lengths are in Metres

I John de LaCouture, Cadastral Surveyor, hereby certify  
that the details shown on this sketch plan are correct.

*John de LaCouture*  
Cadastral Surveyor

8/7/15  
Date

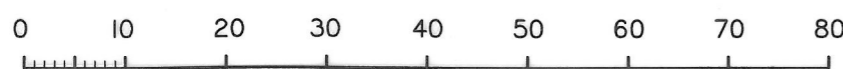

Scale 1: 750 on A3. Lengths are in Metres.

1Z, 202 / 05  
20205\_Level5.dwg (Lease 5B)