

Prepared by:

**JDA Consultants Pty Ltd.**  
Consulting Surveyors & Town Planners.  
ACN 010 272 090  
50 Prospect Street, Fortitude Valley 4006.  
Ph: 07 3252 3777  
Fax: 07 3252 1291  
Email: jdass@jdaconsultants.net.au

For registration plan MUST be to scale.  
(DO NOT REDUCE OR ENLARGE)

Sheet of

**PLAN FOR LEASE PURPOSES**

**Plan Showing :**

Area to be leased (Hatched) being part of the Ground Floor of the building situated on Lot 24 on RP 216272  
Parish : North Brisbane  
County : Stanley  
Title Reference : 18083196

I John Martin Gibson, Cadastral Surveyor, hereby certify that the details shown on this sketch plan are correct.

*JMG*  
Cadastral Surveyor

16/5/2015  
Date



**Note :**

Area calculated as per Property Council of Australia, Method of measurement March 1997, Net Lettable Area. Being measurements taken to the internal finished surfaces of external building walls and glass and also to walls abutting Lifts, Fire Stairs, Toilets and Service/Plant rooms. Measuring to the midline of inter-tenancy walls and to the public face of corridor and lift lobby walls.

**ANN STREET**  
**WHARF STREET**

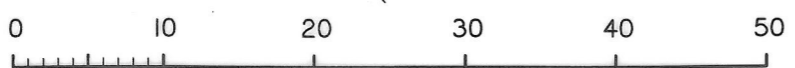
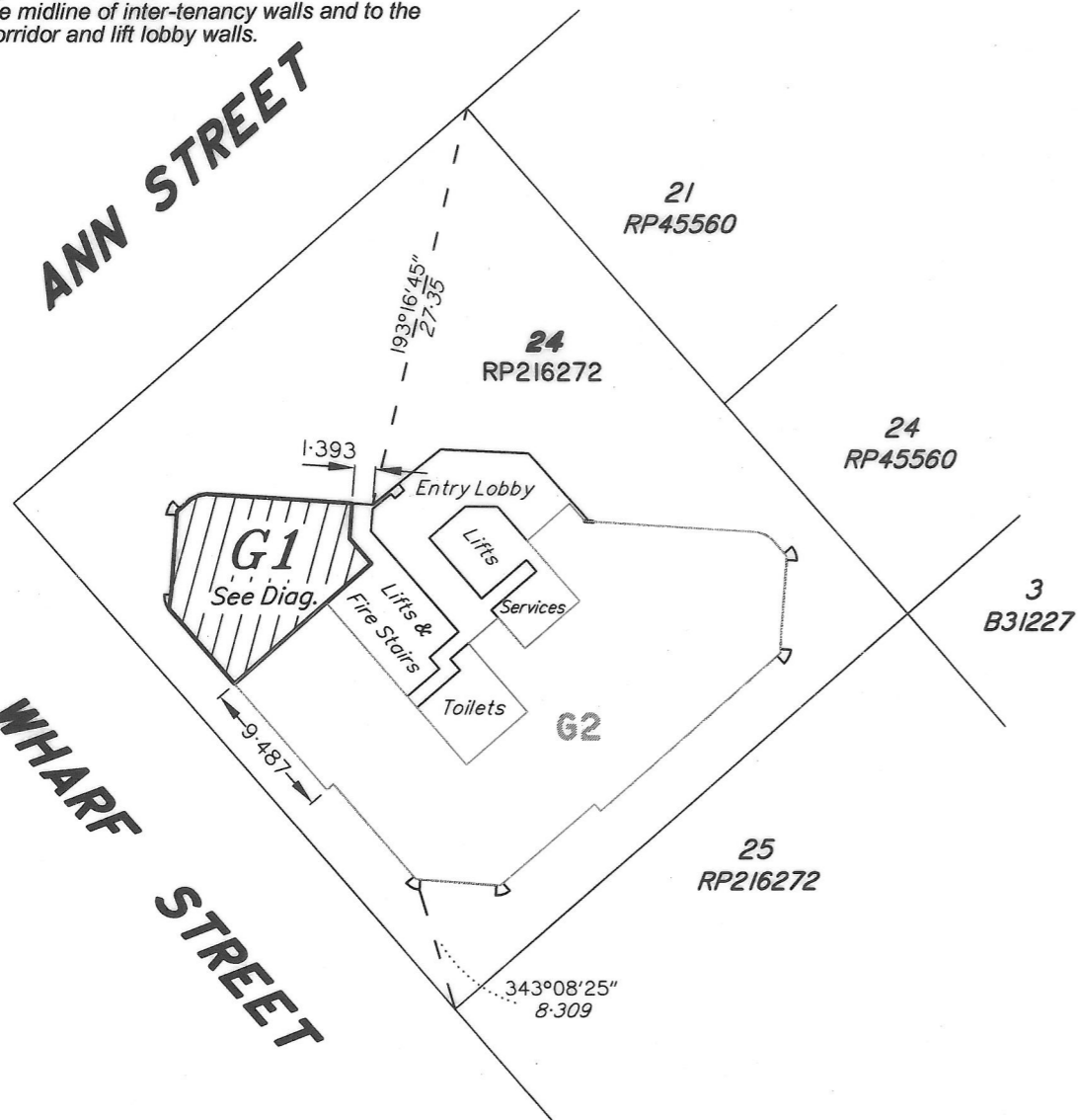

Scale 1: 500 on A3. Lengths are in Metres

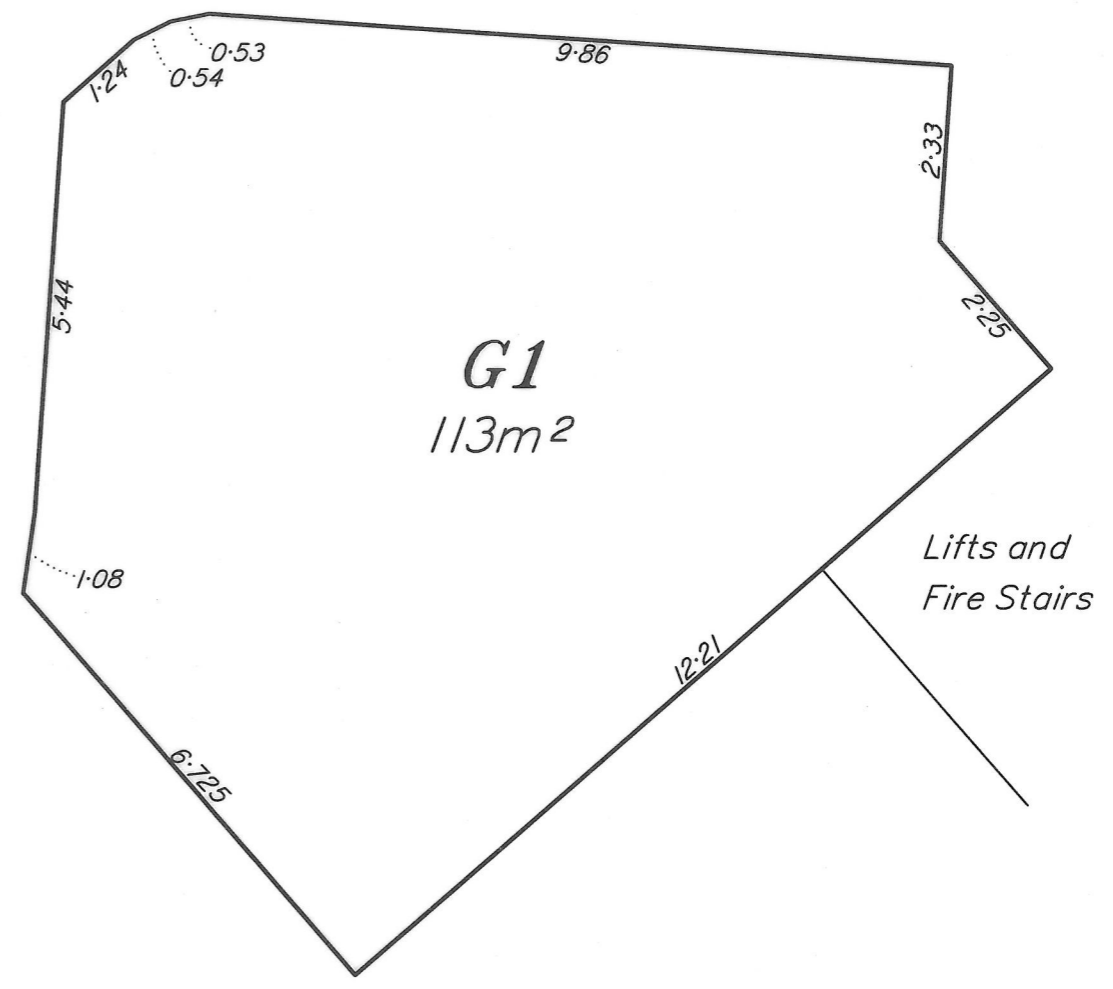

**DIAGRAM**



Scale 1: 100 on A3. Lengths are in Metres