

Prepared by:

JDA Consultants Pty Ltd.
Consulting Surveyors & Town Planners.
ACN 010 272 090
50 Prospect Street, Fortitude Valley
Ph: 07 3252 3777
Fax: 07 3252 1291
Email: jdass@acenet.net.au

PLAN FOR LEASE PURPOSES

Plan Showing:

Area to be leased (Hatched) being part of the Tenth Floor of the building situated on Lot 1 on RP 139280
Parish: Enoggera
County: Stanley
Title Reference: 16391115

Note:

Area Calculated as per the Property Council of Australia, Method of Measurement March 1997, Net Lettable Area. Being measurements taken to the inside face of external building walls & glass, also inside face of walls abutting lifts, fire stairs, toilets, services, and service floor risers. To the corridor side of corridors & public spaces and to the midline of inter-tenancy walls.

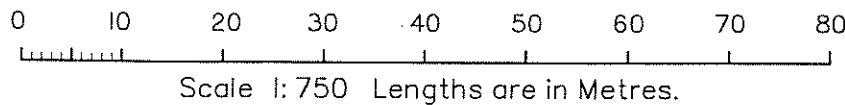
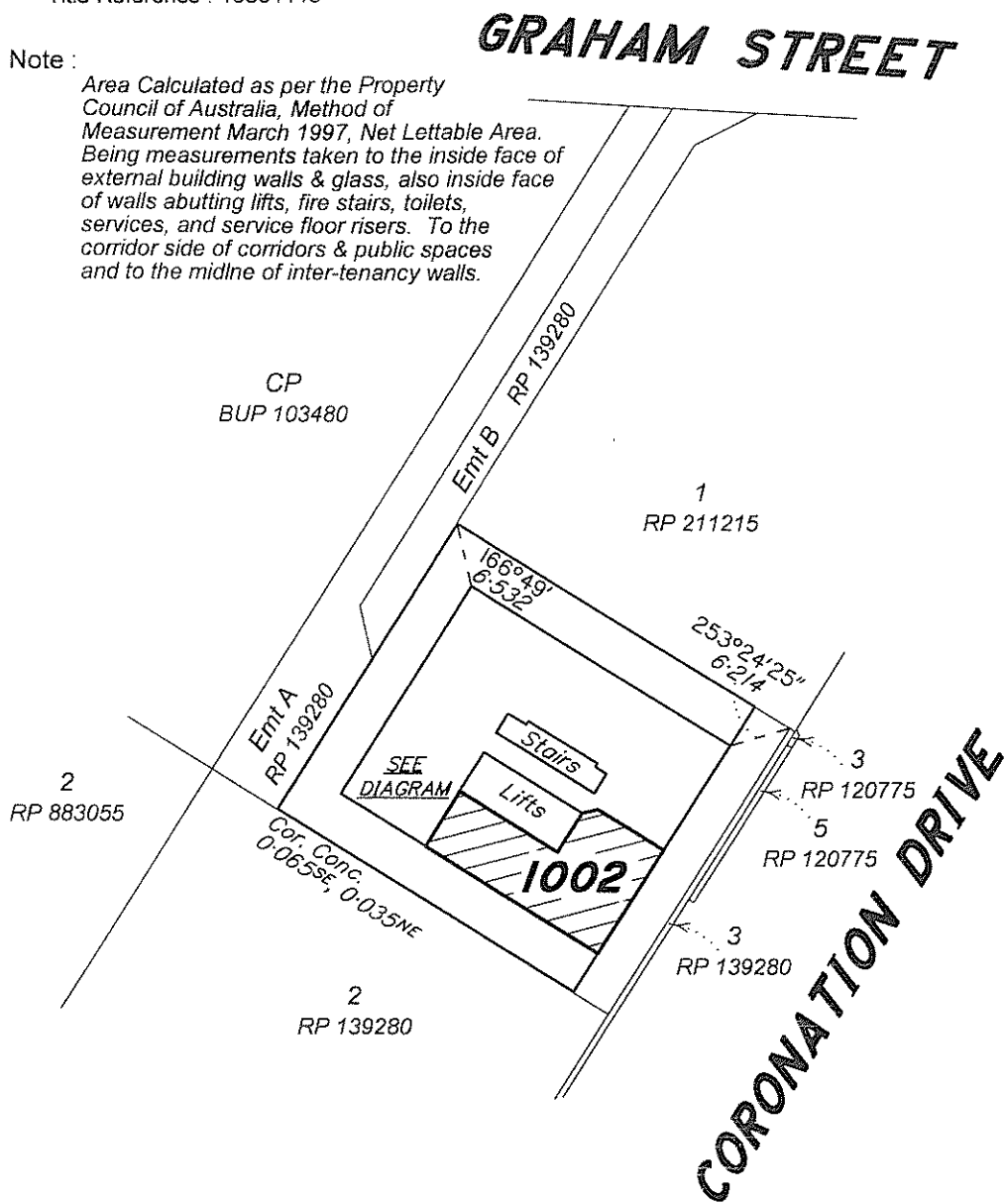

1Z, 152 / 07
152-07a.dwg

For registration plan MUST be to scale.
(DO NOT REDUCE OR ENLARGE)

Sheet	of
-------	----

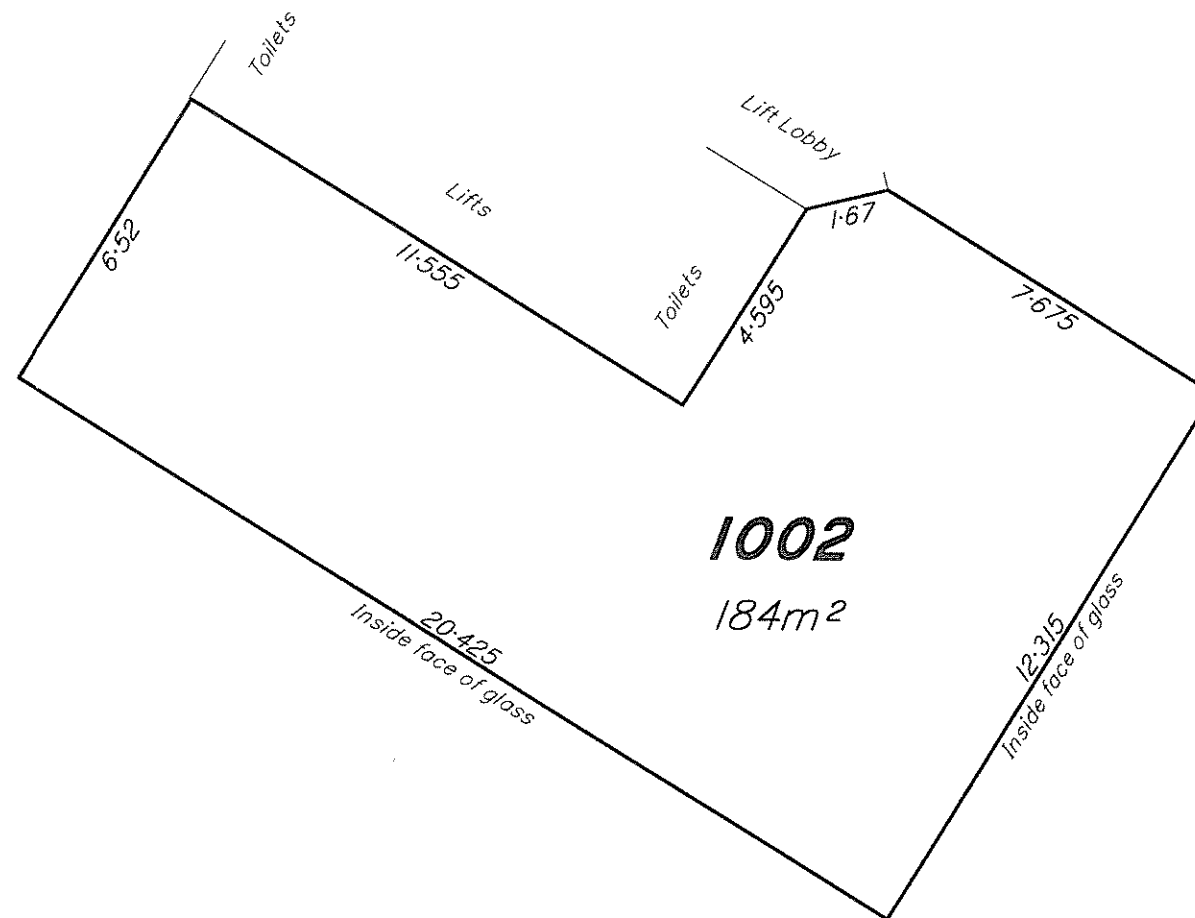

DIAGRAM

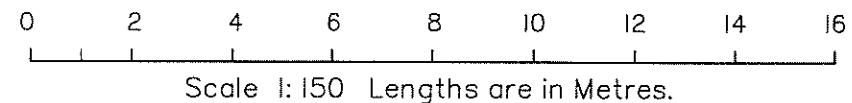

I John Martin Gibson, Cadastral Surveyor, hereby certify that the details shown on this sketch plan are correct.

[Signature]
Cadastral Surveyor

31/3/2011
Date