

Prepared by:

JDA Consultants Pty Ltd.
 Consulting Surveyors & Town Planners.

ACN 010 272 090
 50 Prospect Street, Fortitude Valley
 Ph: 07 3252 3777
 Fax: 07 3252 1291
 Email: jpass@jacentel.net.au

Plan Showing:

Area to be leased (hatched) being part of the Ground Floor of the building situated on Lot 1 on RP 210282
 Parish: North Brisbane
 County: Stanley
 Title Reference: 17528092

Note:

Area calculated as per Property Council of Australia, Method of Measurement March 1997, Gross Lettable Area Retail. Being measurements taken to the inside face of the external building walls, and the main line of external face of walls and glass walls of common area, to the mid line of inter-tenancy walls, walls and corridor side of corridors.

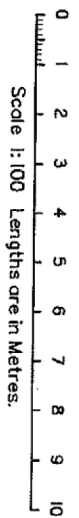
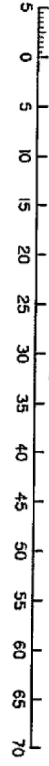
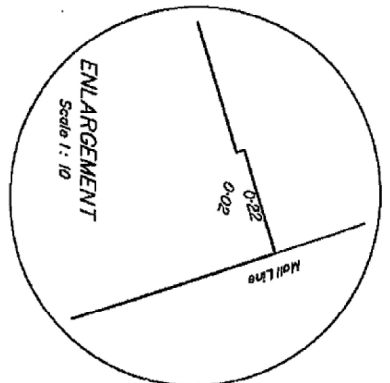
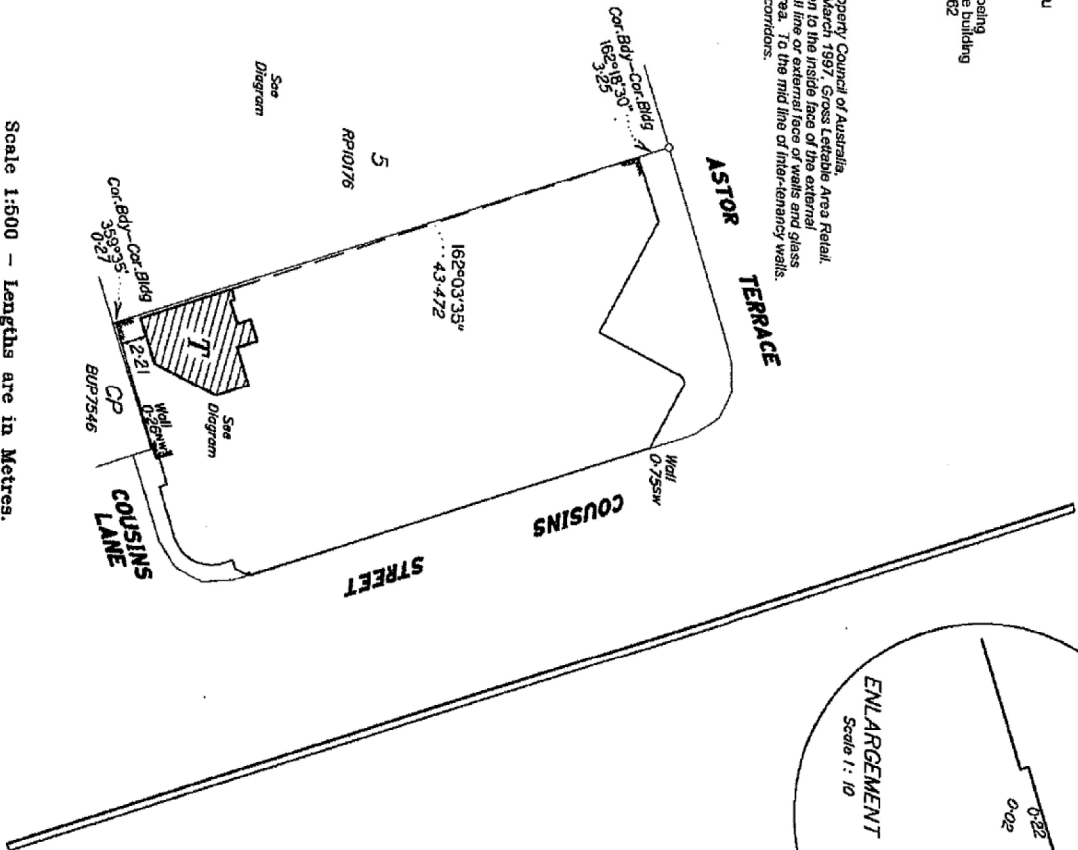

DIAGRAM

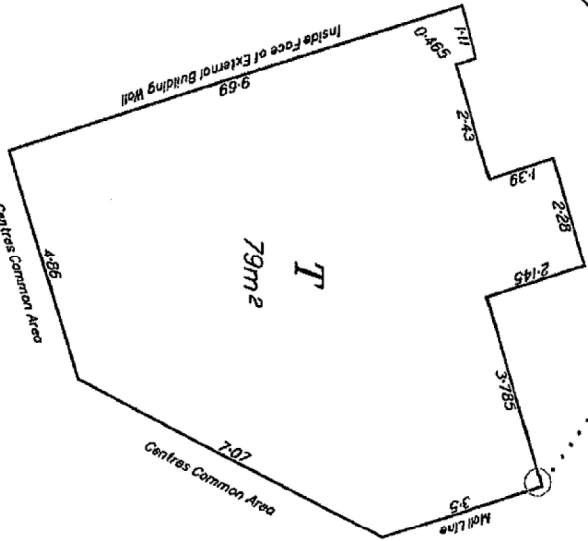

I John de Lacouture, Cadastral Surveyor, hereby certify that the details shown on this sketch plan are correct.

Cadastral Surveyor

Date

1Z, 207 / 04
 20704_Ground Floor Leases.dwg

Sheet	of
-------	----